

FEATURES

- Cement resistors are manufactured by winding the ceramic rods with metal alloy resistance wire and put it in a fireproof ceramic box then concrete with non-flammable and heat-resistant cement.

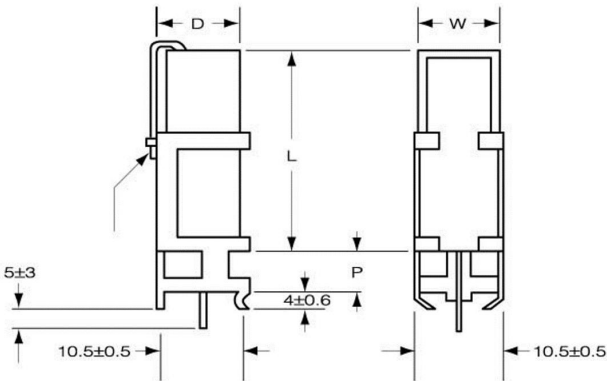

DRAWING and DIMENSIONS (mm)



STYLE	DIMENSIONS (mm)				RESISTANCE	
	W	D	L	P	Wirewound	RS
5W	10.0±2.0	9.0±1.0	22.0±1.0	5.0±2.0	0.1Ω~200Ω	200Ω~50Ω
7W	10.0±2.0	9.0±1.0	35.0±1.0	10.0±2.0	0.1Ω~300Ω	300Ω~50Ω
10W	10.0±2.0	9.0±1.0	48.0±1.0	10.0±2.0	0.1Ω~500Ω	500Ω~50Ω
15W	12.5±2.0	12.5±1.0	49.0±1.0	10.0±2.0	0.1Ω~680Ω	680~50K
20W	13.0±2.0	13.0±1.0	60.0±1.0	10.0±2.0	0.1Ω~820Ω	820~50K

ELECTRICAL CHARACTERISTICS

Style	Power Rating 70°C		
	SQV-5W	SQV-7W	SQV-10W
Operating Temp. Range	-55°C~+155°C		
Max. Working Voltage	350V	500V	500V
Max. Overload Voltage	700V	1000V	1000V
Dielectric Withstanding Voltage (AC)	700V	1000V	1000V
Temp. Coefficient	±300ppm/°C		

- * a. Standard resistance is as the above list, below or over this resistance is on request.
- b. Value for NKN Non-Inductive type is up to 50Ω only.

FIG.1 DEARATING CURVE

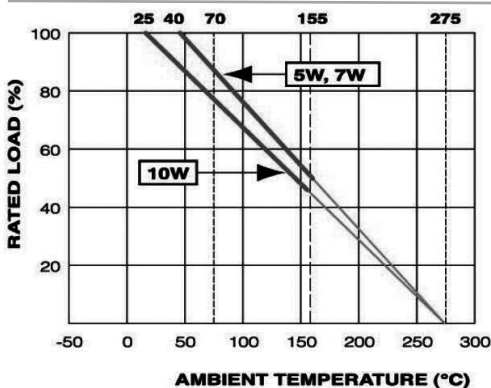
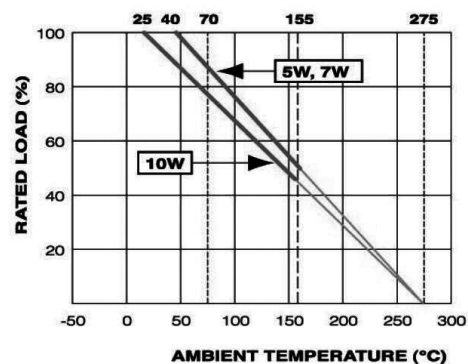

FIG.2 TEMPERATURE RISE



Note: Other resistance is available on request. WEET is capable of doing custom service for you.



WEE Technology Company Limited
FLAT/RM 705, 7/F,
FA YUEN COMM BLDG NO.75,
FA YUEN STREET, MONG KOK, KL, HK
www.weetcap.com
info@weetcap.com

All details in this data sheet are subject to change without notice. For more details and updates, please visit our website.

Copyright © 2000 WEE Technology, All rights reserved.

