

FEATURES

Single Turn/ Cermet/ Industrial/ Sealed.
Many Terminal Styles.

DRAWING (mm)

WTP-3386

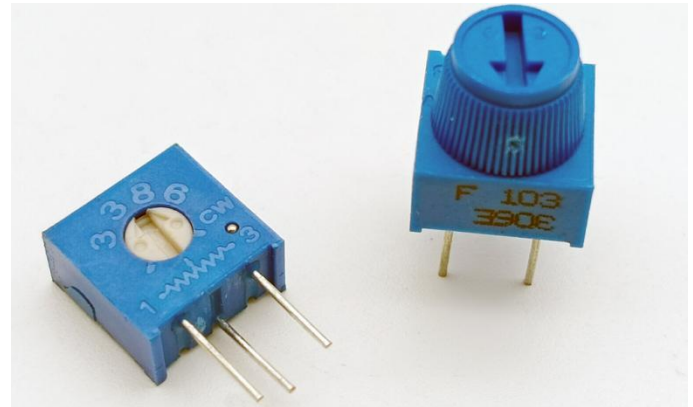
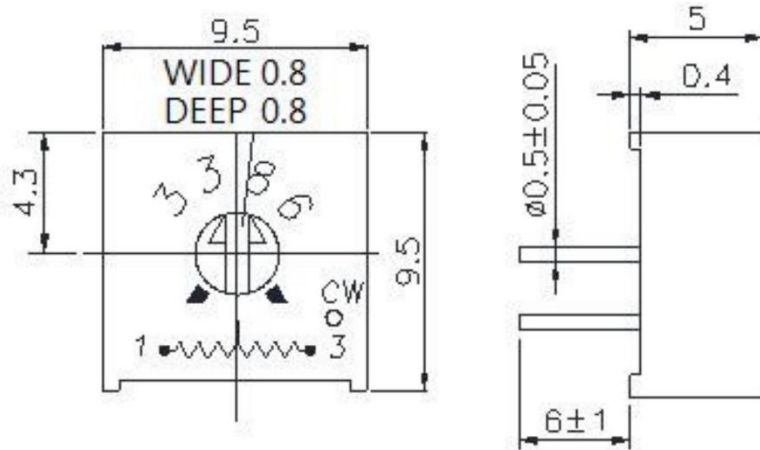

WTP-3386P

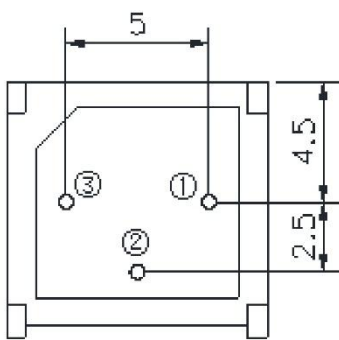

WTP-3386F

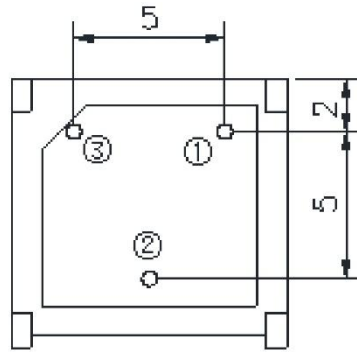

WTP-3386Y

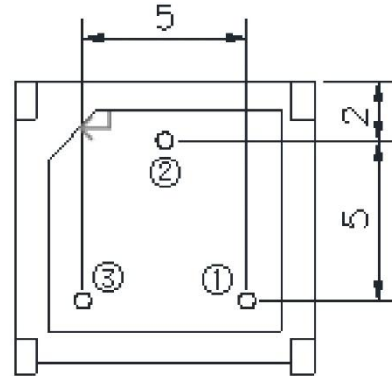

WTP-3386H

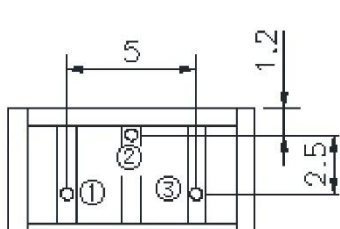

WTP-3386X

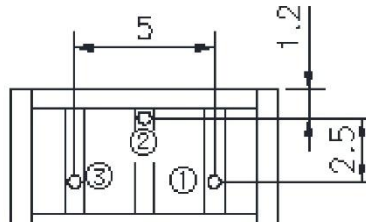

WTP-3386W

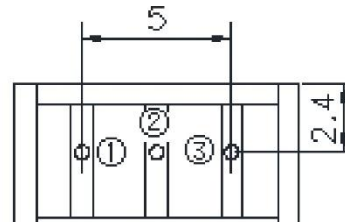

WTP-3386C

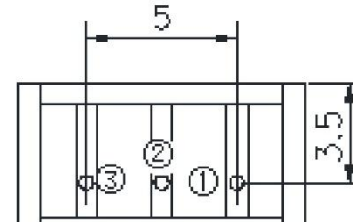

WTP-3386(STYLE)-EY5-(RESISTANCE CODE)

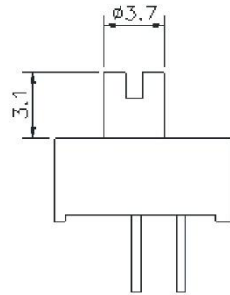

WTP-3386(STYLE)-EY5-(RESISTANCE CODE)-T

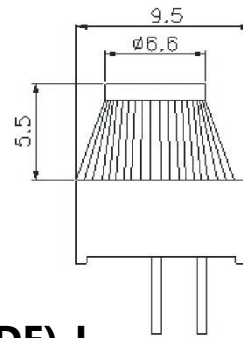

WTP-3386 F,K,P,R,U,Y-EY5(RESISTANCE CODE)-L

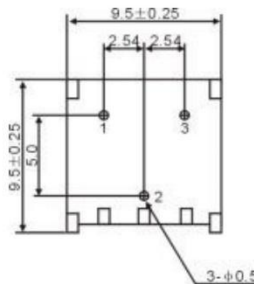
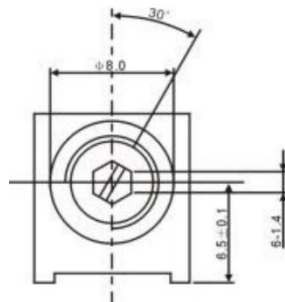
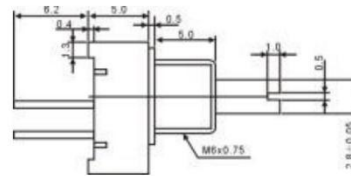
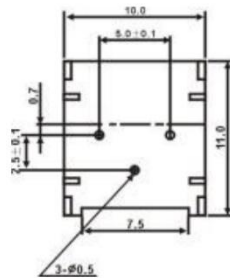

WTP-3386 F,K,P,R,U,Y-EY5(RESISTANCE CODE)-TL

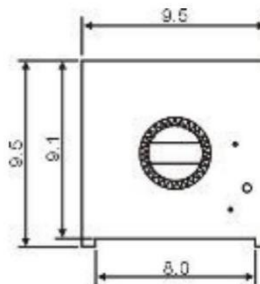
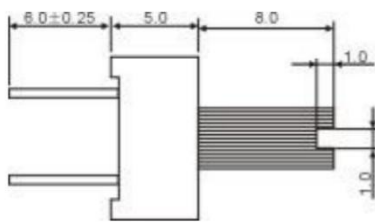

WIPER 2(d)

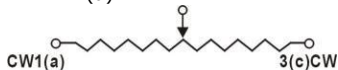

CLOCKWISE

Tolerance is ±0.25 if no identification

WEE Technology Company Limited
FLAT/RM 705, 7/F, FA YUEN COMM
BLDG NO.75, FA YUEN STREET, MONG
KOK, KL, HONG KONG
www.weetcap.com
info@weetcap.com

All details in this data sheet are subject to change without notice.
For more details and updates, please visit our website.

Copyright © 2000 WEE Technology, All rights reserved.



SPECIFICATIONS

| Electrical Characteristics | |
|-----------------------------------|-------------------------------------------|
| Standard Resistance Range | 10Ω - 5MΩ |
| Resistance Tolerance | ±10% ; ±20% for 10, 20 and 2M ohm |
| Absolute Minimum Resistance | ≤ ±1%R or 10Ω |
| Contact Resistance Variation | CRV ≤ ±3%R or 5Ω (whichever is larger) |
| Insulation Resistance | R1 ≥ 1GΩ(500Vdc) |
| Withstand Voltage | 640VAC |
| Effective Travel | 260° |

| Environmental Characteristics | |
|--------------------------------------|--------------------------------------------------------------------------------|
| Power Rating (300volts max) | 0.5W@70°C, 0W@125°C |
| Temperature Range | -55°C ~ +125°C |
| Temperature Coefficient | ±200x10 ⁻⁶ /°C (±100ppm/°C on request) |
| Temperature Variation | -55°C,30min, +125°C/30min,5 cycles ΔR ≤ ±2%R.Δ(Uab/Uac) ≤ ±2%R |
| Collision | 390m/s ² ,4000cycles,ΔR ≤ ±1%R |
| Electrical Endurance at70°C | 0.5W@70°C, 1000hΔR ≤ ±(5%R+0.1Ω), CRV ≤ ±3%R or 5Ω (whichever is larger) |
| Rotational Life | 200 cycles ΔR ≤ ±(10%R+0.5 Ω),CRV ≤ ±3%R or 5 Ω (whichever is larger) |

| Physical Characteristics | |
|---------------------------------|----------------------------------------------------------------------------------------|
| Starting Torque | ≤35mN·m |
| Marking | Resistance Tolerance (When no identification,it is of ± 10%) Resistance Code, Model |
| Standard Packaging | 50pcs, per tube |



WEE Technology Company Limited
FLAT/RM 705, 7/F, FA YUEN COMM
BLDG NO.75, FA YUEN STREET, MONG
KOK, KL, HONG KONG
www.weetcap.com
info@weetcap.com

All details in this data sheet are subject to change without notice.
For more details and updates, please visit our website.

Copyright © 2000 WEE Technology, All rights reserved.



PN STRUCTURE

WTP-3386W-103-R

| <u>WTP</u> | <u>3386</u> | <u>W</u> | <u>103</u> | <u>R</u> |
|---------------|-------------|--------------|-------------------|-------------|
| <u>Series</u> | | <u>Style</u> | <u>Resistance</u> | <u>RoHS</u> |
| 1 | | 2 | 3 | 4 |

3. Resistance (Special Resistances Available)

| Resistance Code | Resistance (Ohms Ω) | Resistance Code | Resistance (Ohms Ω) |
|-----------------|---------------------|-----------------|---------------------|
| 100 | 10 | 203 | 20,000 |
| 200 | 20 | 223 | 22,000 |
| 500 | 50 | 253 | 25,000 |
| 101 | 100 | 303 | 30,000 |
| 151 | 150 | 333 | 33,000 |
| 201 | 200 | 473 | 47,000 |
| 251 | 250 | 503 | 50,000 |
| 301 | 300 | 683 | 68,000 |
| 471 | 470 | 104 | 100,000 |
| 501 | 500 | 154 | 150,000 |
| 681 | 680 | 204 | 200,000 |
| 102 | 1,000 | 224 | 220,000 |
| 152 | 1,500 | 254 | 250,000 |
| 202 | 2,000 | 304 | 300,000 |
| 222 | 2,200 | 334 | 330,000 |
| 252 | 2,500 | 474 | 470,000 |
| 302 | 3,000 | 504 | 500,000 |
| 472 | 4,700 | 684 | 680,000 |
| 502 | 5,000 | 105 | 1,000,000 |
| 682 | 6,800 | 205 | 2,000,000 |
| 103 | 10,000 | 225 | 2,200,000 |
| 153 | 15,000 | 505 | 5,000,000 |



WEE Technology Company Limited
FLAT/RM 705, 7/F, FA YUEN COMM
BLDG NO.75, FA YUEN STREET, MONG
KOK, KL, HONG KONG
www.weetcap.com
info@weetcap.com

All details in this data sheet are subject to change without notice.
For more details and updates, please visit our website.

Copyright © 2000 WEE Technology, All rights reserved.

